

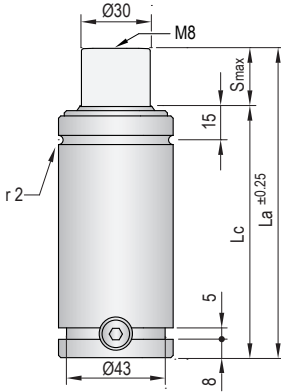

VDI SAFETY

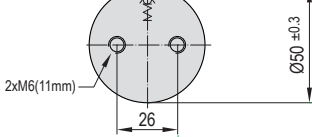

Gas charging G1/8  
TPFV5 valve  
G1/8 adapter



**i** Pressure medium **Nitrogen (N<sub>2</sub>)**

Max. charging pressure	150 Bar
Min. charging pressure	50 Bar
Piston seal area	12,57 cm <sup>2</sup>
Operating temperature	0°C - 80°C
Force increase by temperature	0,33 %/°C
Max. stem speed	25 m/min
Maintenance kit	Kit FS2000.2



Maximum strokes / minute (at 20°C)

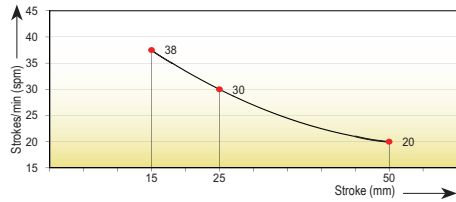

Code	Smax mm	La mm	Lc mm		Fa daN		F daN		Fc daN		P Bar	V l		Kg
TPFS 2000x16.2	16	95	79				2730		3015			0,055		0,70
TPFS 2000x25.2	25	125	100	2000 ±5% (20°C)			2725		3000	150 (20°C)		0,082		0,81
TPFS 2000x50.2	50	200	150				2815		33135			0,151		1,05

Force/stroke ratio

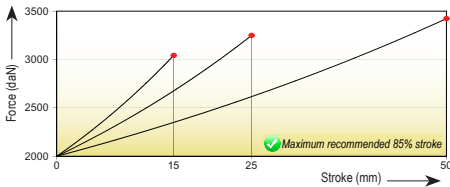

Initial force/charging pressure ratio

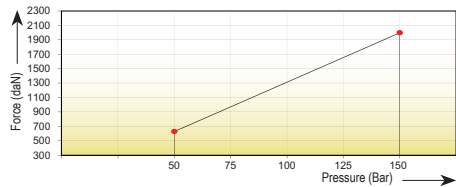

Assembly possibilities



Follow guidelines  
Page 287



DROP-IN



SCREWS

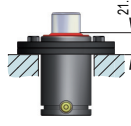

FS 50-FSC 50

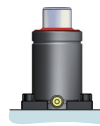

FP 50-FPR 50

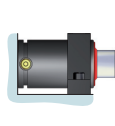

FI 50-FI 50/1

TPF

TPK

TPC

TPR

TPB

TPHC

TPA

TPG

TPCT

TPSL

STOP CYLINDER

STOP CYLINDER

TPSR

TPSR5

TPNS

TPHT

